

LM-AN TYPE

※ Nut Type

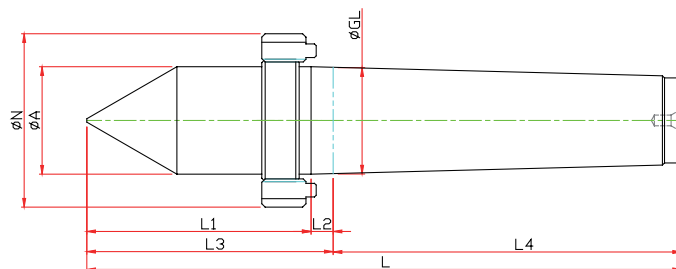

unit:mm/kg

Model	Morse Taper	Dimension								Run out (inch)
		GL	A	L1	L2	L3	L4	N	L	
LM-1AN	NO.1	12,065	12,2	31,5	5	36,5	53,5	M16	90	0,00011811
LM-2AN	NO.2	17,780	18	41,5	6,5	48	64	M22	112	0,00011811
LM-3AN	NO.3	23,825	24	49,5	7,5	57	81	M27	138	0,00011811
LM-4AN	NO.4	31,267	31,6	62,5	10	72,5	102,5	M36	175	0,00011811
LM-5AN	NO.5	44,399	44,7	77	11	88	129,6	M48	217,5	0,00011811
LM-6AN	NO.6	63,348	63,8	96,5	11,5	108	182	M68	290	0,00019685
LM-7AN	NO.7	83,058	83,6	108,5	11,5	120	250	M90	370	0,00019685

※SPECIAL sizes or dimensions are available with quick turnaround

LM-CN TYPE

※ Carbide, Nut Type

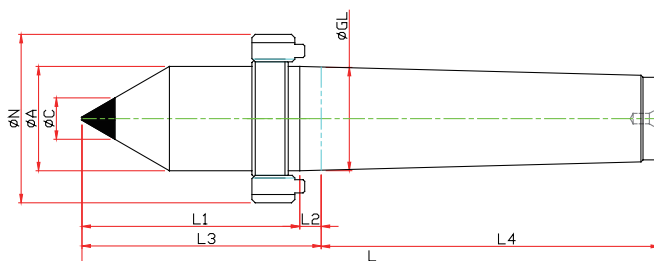

unit:mm/kg

Model	Morse Taper	Dimension									Run out (inch)
		GL	A	L1	L2	L3	L4	C	N	L	
LM-1CN	NO.1	12,065	12	31,5	5	36,5	53,5	7	M16	90	0,00011811
LM-2CN	NO.2	17,780	18	41,5	6,5	48	64	7	M22	112	0,00011811
LM-3CN	NO.3	23,825	24	49,5	7,5	57	81	10	M27	138	0,00011811
LM-4CN	NO.4	31,267	32	62,5	10	72,5	102,5	14	M36	175	0,00011811
LM-5CN	NO.5	44,399	45	77	11	88	129,5	18	M48	217,5	0,00011811
LM-6CN	NO.6	63,348	64	96,5	11,5	108	182	18	M68	290	0,00019685

※SPECIAL sizes or dimensions are available with quick turnaround

LM SPECIAL

※ Customized-special production for user's condition

